

SECTOR - 69

S.A.S. NAGAR  
SECTOR - 78

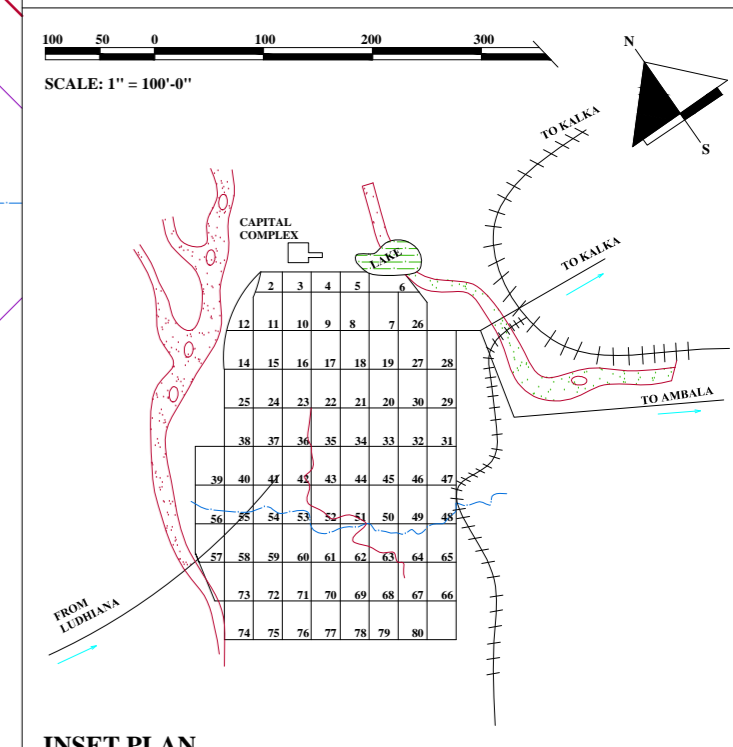
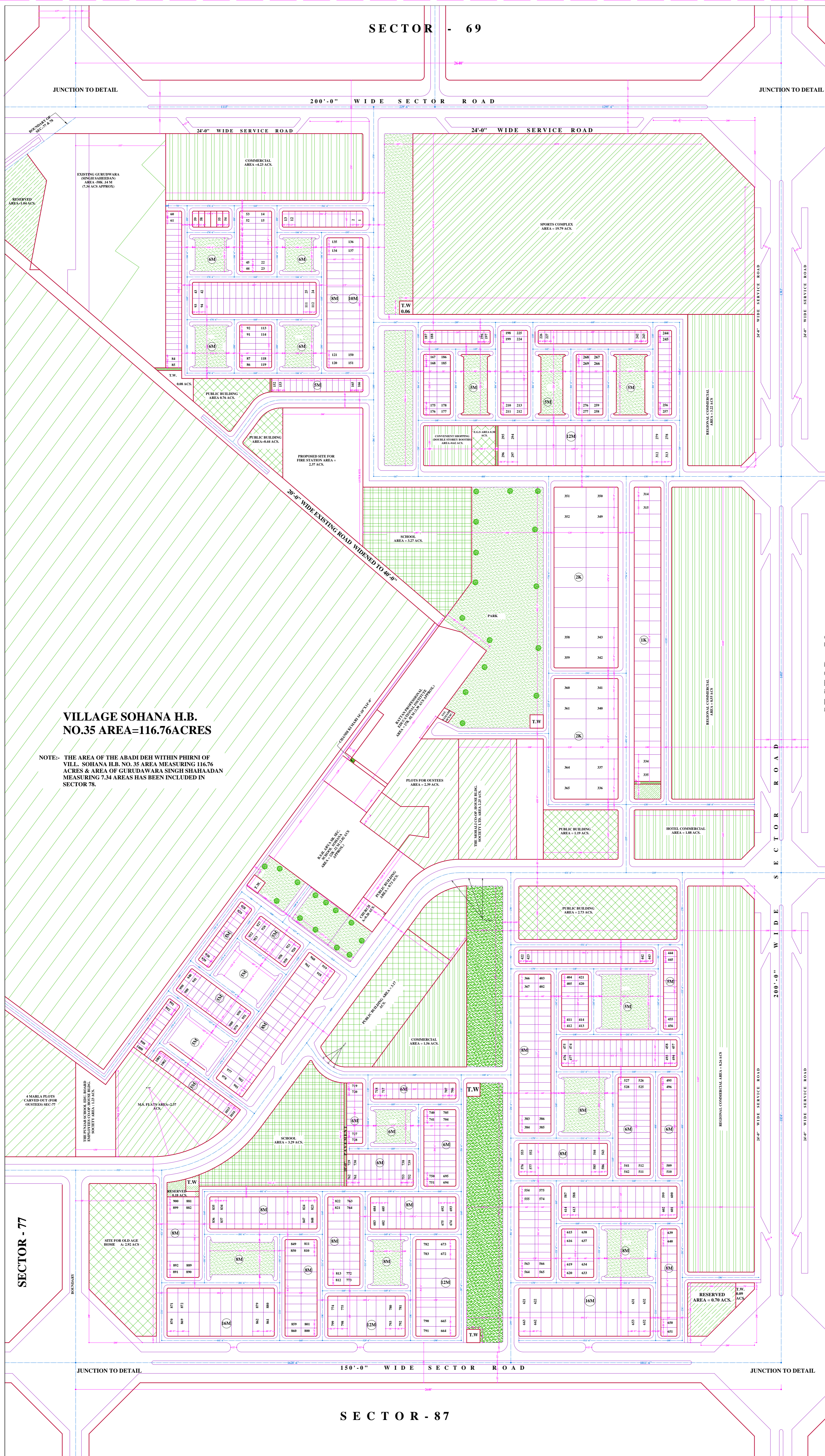

**LEGEND:-**

- Residential
- Multistoried flats
- Existing village sohana
- Commercial
- Educational
- Medical
- Public buildings
- Reserved
- Roads & open spaces
- Bus terminus
- Tube well
- Pavement

**DETAIL OF AREAS:-**

Area	AREA IN ACS.	%AGE
Gross area of sector 78 (including vill. Sohana & gurudawara singh shaheedan)	356.99	
Area under peripheral roads	23.20	
Area of institutions exempted	7.34	
Gurudawara Singh Shaheedan	3.39	15.51
Rattan Professional Edu. Society	2.82	
B.S.H. Arya School	116.76	
Area under village abadi	203.48	
Net planned area		
Area under residential including m.s. flats	53.45	26.27%
Area under commercial	28.52	13.92%
Area under educational	6.56	3.22%
Area under public building	13.15	6.46%
Area under bus stand	19.39	9.53%
Area under vet. hospital	1.42	0.70%
Area under religious	0.04	0.02%
Area under reserved	2.84	1.00%
Area under l.w.	0.29	0.14%
Area under roads & open spaces	78.82	38.74%
	203.48	100 %

**SCHEDULED OF PLOTS:-**

JUNCTION BETWEEN ROAD	RADIUS
200 150	As per junction detail
200 100	As per junction detail
200 80	As per junction detail
150 100	As per junction detail
150 80	As per junction detail
100 100	35'-0"
100 80	35'-0"
100 60	30'-0"
100 40	25'-0"
80 80	30'-0"
80 60	30'-0"
80 40	25'-0"
60 60	25'-0"
60 40	20'-0"
40 40	15'-0"
40 24	15'-0"

**DETAIL OF RADII OF ROADS JUNCTION:-**

JUNCTION BETWEEN ROAD	RADIUS
200 150	As per junction detail
200 100	As per junction detail
200 80	As per junction detail
150 100	As per junction detail
150 80	As per junction detail
100 100	35'-0"
100 80	35'-0"
100 60	30'-0"
100 40	25'-0"
80 80	30'-0"
80 60	30'-0"
80 40	25'-0"
60 60	25'-0"
60 40	20'-0"
40 40	15'-0"
40 24	15'-0"

- NOTES:-**
- All measurements are to be exact & should be checked at site.
  - All dimensions are to be taken from the centre line of carriage way which are shown in dash & dots.
  - Detail of commercial pockets shall be supplied later.
  - The layout cum demarcation plan has been approved by chief town planner vide encl. no. 1668-c.p. (ph.) /sc-114 dated 28.7.2004 and in p & d committee meeting held on dt. 25.04.2011.
  - Tube well sites 7 nos. has been incorporated as per plans supplied by divisional engineer (ph-i) vide his letter no. d.e.(ph-i)/07/3469 dated 12.6.07. l.w. site area 0.09 acs. near junction sector 78-79 near reserved area has been merged in reserved pocket total area 0.70 + 0.09 = 0.79 acs. as per detailed in rpt meeting dated:-
  - Site for the mohali co-op house bldg. society ltd. allotted as per gmada's letter no. (gmada) / 2011/5861 dt. 25.04.2011.
  - Site for the panjab school education board employees co-op house bldg. society allotted as per gmada's letter gmada (policy) /2011/5865 dt. 25.04.2011.
  - Site for fire brigade station has been allotted as per gmada's letter no. gmada (policy) /2011/5900 dt. 27.04.2011 in lieu of veterinary hospital.
  - Site for church has been allotted vide gmada encl. no. gmada (c.a./2012/ 4109 dated 13.2.2012
  - Planning of a marla size plots for outsties of sector-76 to 80 (near B.S.H. Arya School) has been approved by chief town planner panjab vide memo no. 629 sc-114 vol.-3 dt. 31-01-2013

**NOTE:-**  
THIS DIGITIZED DRAWING IS BASED ON THE ORIGINAL DRAWING OF THE CONCERNED DEPARTMENT. IN CASE OF ANY DISCREPANCY THE DETAILS IN THE ORIGINAL DRAWING SHALL PREVAIL UPON.

**LAYOUT CUM DEMARCATION PLAN**  
**OFFICE OF THE DIVISIONAL TOWN PLANNER**  
**S.A.S. NAGAR**

DRG. NO: D.T.P. (S.A.S. nagar) /1688/2003 DATED: 14.7.2003

TRACED BY: - Sd -      CHECKED BY: - Sd -

- Sd - Planning Officer	- Sd -	- Sd -	- Sd -
Asst. Town Planner	dist. Town Planner	Senior Town Planner	Chief Town Planner

**VILLAGE SOHANA H.B. NO.35 AREA=116.76ACRES**

NOTE:- THE AREA OF THE ABADI DEH WITHIN PHIRNI OF VILL. SOHANA H.B. NO. 35 AREA MEASURING 116.76 ACRES & AREA OF GURUDAWARA SINGH SHAHADAN MEASURING 7.34 ACRES HAS BEEN INCLUDED IN SECTOR 78.

SECTOR - 87